



FITTING INSTRUCTION

2-DIN KIT - ALFA ROMEO GIULIETTA



A

Anti-vibration self-adhesive foam

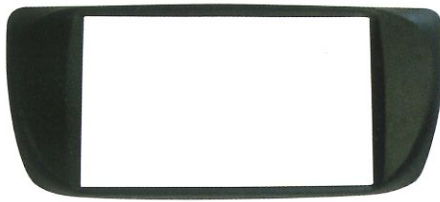

B

Radio trim



C

Mounting Brackets



D

Nuts, bolts (M5x 12mm) and washers (x 4 sets)



E

Bolts (M5 x 6mm)



F

Spring washers

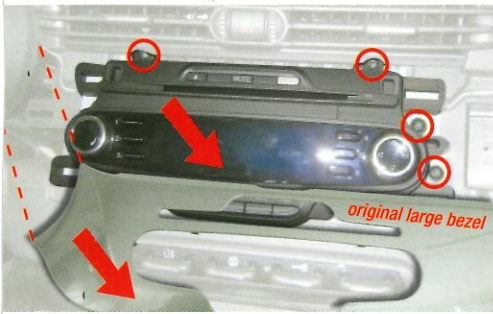

1. Remove the original large bezel by gently pulling away, and remove the radio with bolts as shown.

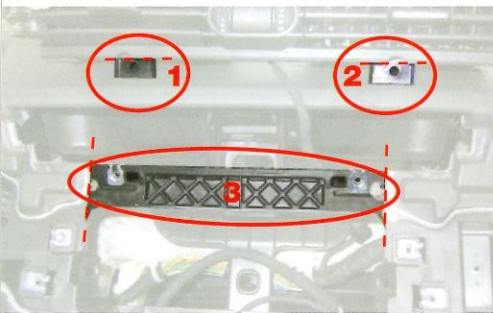

2. Remove the 3 parts (1,2,3) as shown by cutting carefully where shown by the dotted line(s).

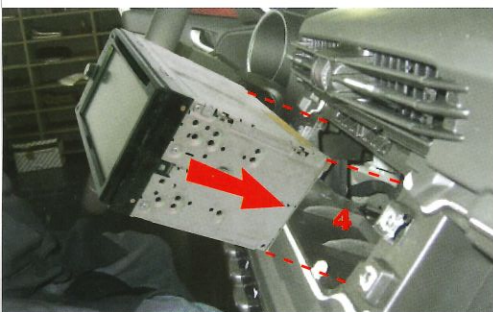

3. Insert the new head unit to check all interfering parts (1,2,3 above) have been correctly removed, and check alignment of unit.

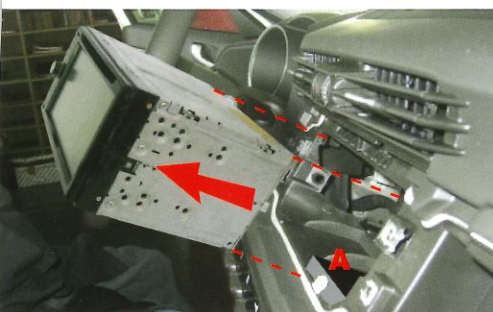

4. Remove the head unit and apply the self adhesive foam (A) to help support the unit, as shown.

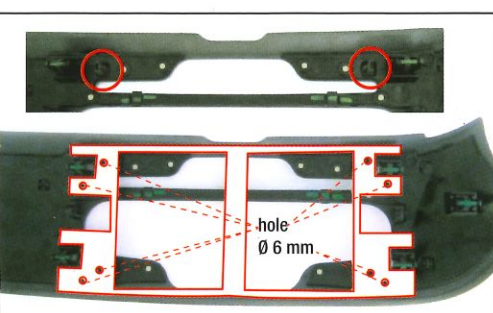

5. Very carefully, cut the original bezel trim using the template shown. If the original bezel cannot fit correctly due to the tabs on the rear, they can be cut off. (see figure).

6. Fix the brackets (C) Left (Sx) and Right (Dx) onto the original bezel from the front, using the M5x12mm bolts, washers and nuts (D). Do not fully tighten at this stage.

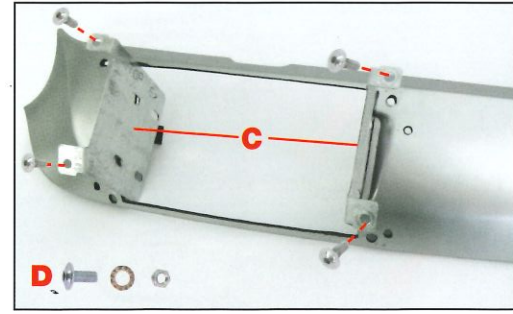

7. Position the head unit between the brackets, and align so visually straight. Fix using the M5x6mm bolts (E). Do not fully tighten at this stage.

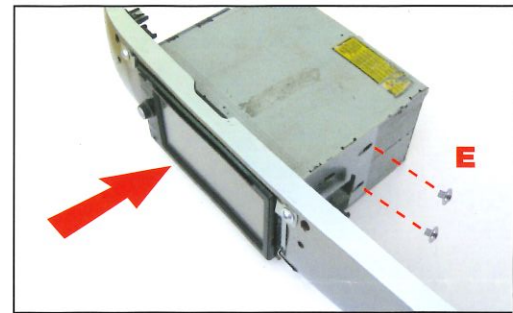

8. Place the Radio Trim (B) onto the original bezel, locating the 4 legs through the holes previously drilled. Ensure the position of the head unit and trim is correctly aligned.

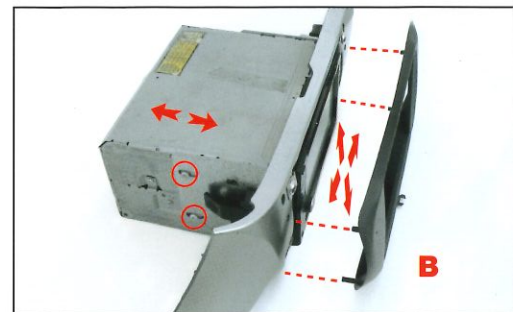

9. Push the spring washers (F) onto the legs of the radio trim, and tighten all bolts (as shown), ensuring the head unit is visually aligned as required.

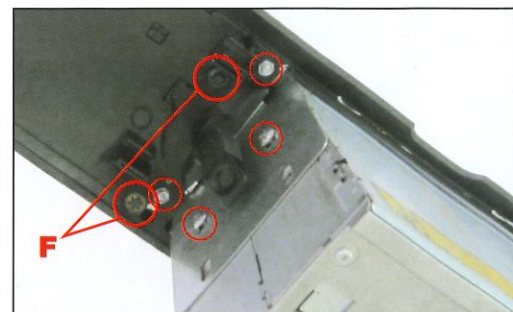

10. The complete assembly is now ready to be re-installed in the vehicle.

